

ANTHEM GOLF & COUNTRY CLUB RENTAL HOUSE

Like New Home with Nice Upgrades!

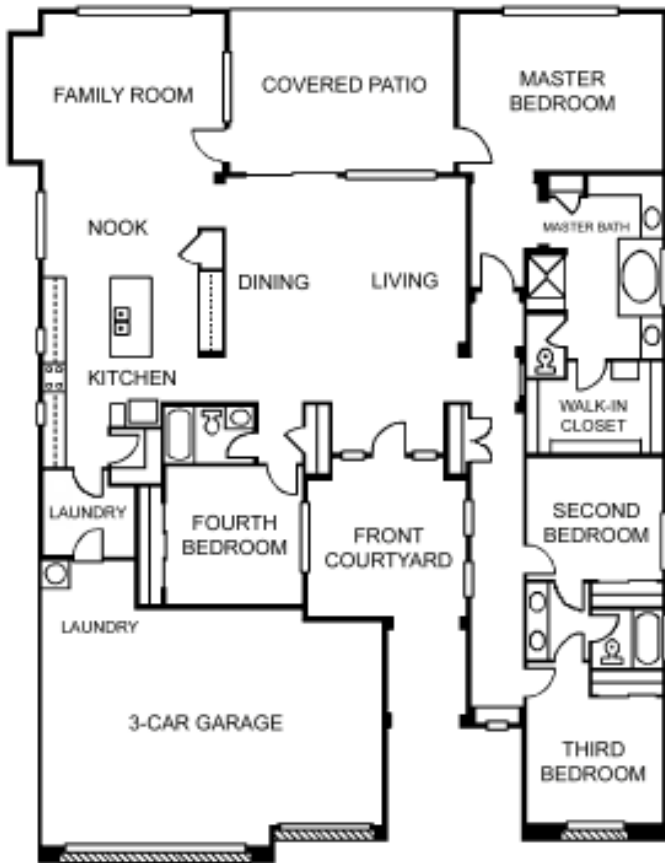

“Cascade” Series “Tacoma” Floor Plan:



This Desirable Home Features:

- 4 Bedrooms
- 3 Bathrooms
- 3-Car Garage with Opener
- Covered Patio
- 2,792 sq. ft. per Builder
- Granite-slab Kitchen Countertops
- Gas Cooktop
- Stainless-steel Built-in Microwave
- Stainless-steel Built-in Oven
- Stainless-steel Dishwasher
- Stainless-steel Undermount Kitchen Sink
- Cherry Cabinets Throughout
- Water Softener and R/O System
- Wood Shutters on Windows
- Jetted Tub in Master Bathroom
- Large Floor Tile and New Carpet
- Two-tone Interior Paint
- Landscaped Front and Back Yards
- Private Backyard with Mountain Views
- Owner pays HOA and Club Dues

For Lease \$1,650 per month

For more information, please contact
Campbell & Associates LLC
www.CampbellRealtors.net

Doug Campbell, Realtor/Broker
Doug@CampbellRealtors.net
(623) 261-6198



All information provided is deemed reliable but is not guaranteed. Buyer should verify the accuracy of information provided to their satisfaction.

